

# The University of Hong Kong

## Yealink EXP50 – Teams Edition User Quick Reference

- The Yealink EXP50 Expansion Module is compatible with MP56 Yealink Teams Phones.
- The Expansion Module has three pages of keys with 20 keys on each page for a total of 60 additional keys.
- A total of three Expansion Modules can be added to each phone set.
- The keys can be programmed as extensions, speed dials or features by System Administrator.

The main physical features of the EXP50 expansion module are described below:

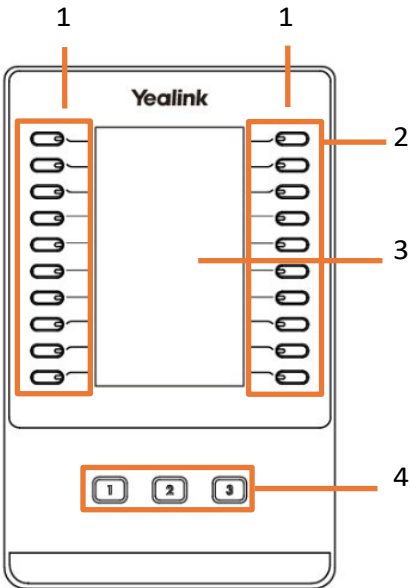

No	Item	Description
1	Ext Keys	Can be assigned as busy lamp fields, speed dials or features.
2	LED Indicators	Appear on the key and when programmed as a BLF, show the user's telephone status.
3	Color LCD Screen	Shows the key feature label and icon.
4	Page Keys	Press these keys to navigate to other pages to view additional keys.

### Icon / LCD Status Indicators

Icon	LCD Light	Status
	No Light	User is available.
	Fast Flashing GREEN	User's line is ringing.
	Solid RED	User is on a call.
	Slow Flashing RED	User is on DND.
	No Light	User is logged out.
	No Light	Key is programmed as a Speed Dial.

This chart represents the Icon and LCD Status indicator representations.

## **TRANSFER USING ADVANCED MONITOR EXTENSION (BLF) KEYS**

TRANSFER allows you to connect your call to someone else (with call on the line)

1. Press either the **TRANS** Softkey or Press the TRANSFER Key on the phone.
2. The current call is automatically placed on hold.
3. Press an ENHANCED MONITOR EXTENSION (BLF) KEY
4. Wait for the person to answer, announce the call.
5. COMPLETE TRANSFER: Press the TRANSFER Softkey, call is connected, hang up.

TO RETURN TO HELD CALL: Press the CANCEL Softkey and then press the RESUME Softkey.

**Blind Transfer:** Press an ENHANCED MONITOR EXTENSION (BLF) KEY. The call is automatically transferred.

**NOTES:** Additional programming is required to use the BLF keys to transfer. To program a Busy Lamp Field (Enhanced Monitor Extension) Key, please check with your IT support colleagues or ITS Service Desk.

End.

# The University of Hong Kong

## Yealink EXP50 – Teams Edition User Quick Reference

### Installation

The EXP50 color-screen expansion module applies to Yealink MP56 Teams phones. To easily connect the EXP50 to the phone, please unplug the phone stand from the IP phone.

#### To unplug the stand from the IP phone:

1. Unplug the power adapter and Ethernet cable from the IP phone.
2. Unplug the handset attached to the IP phone.
3. Turn the IP phone over and lay it on a non-slip, flat surface.
4. Unplug the stand from the IP phone.

#### To connect the EXP50 color-screen expansion module:

1. Turn over the phone and expansion module, and lay them on a flat, non-flat, non-slip surface.
2. (Optional) The slots of IP phone may be plugged up by silica gel. You can pull out the silica gel.
3. Connect the EXP50 color-screen expansion module and the IP phone using the supplied connecting sheet and screw.

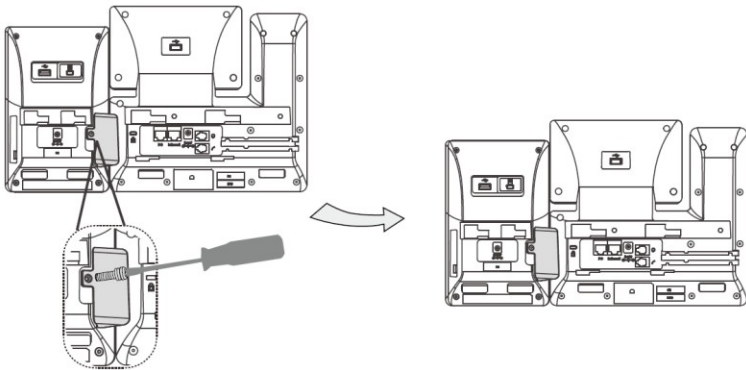

If you want to connect two or more expansion modules, pull out the silica gel and connect two expansion modules as below:

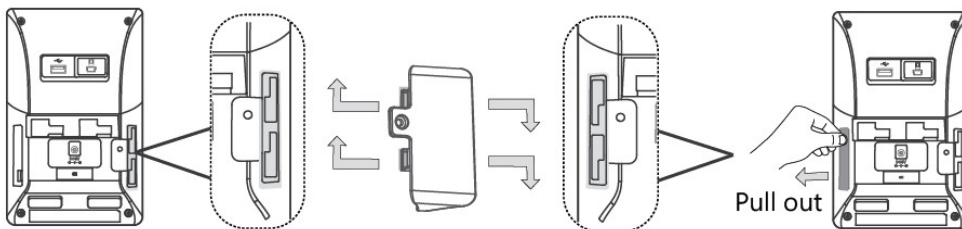

Connecting two expansion modules on a single host phone is shown as below:

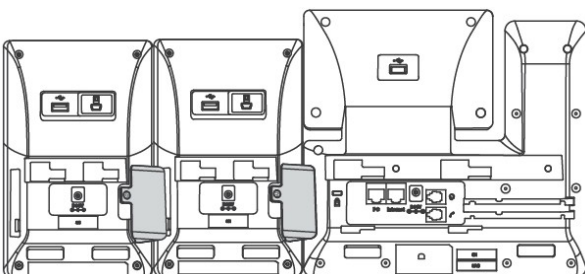

4. Connect the USB jack on the host phone and the mini USB jack on the expansion module using one supplied cable.

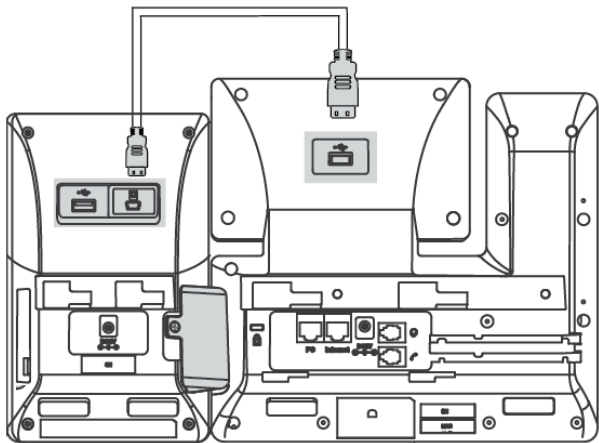

If you connect two expansion modules, connect the USB jack on the prior expansion module and the mini USB jack on the next expansion module using another supplied cable. Connecting two expansion modules on a single host phone is shown as below:

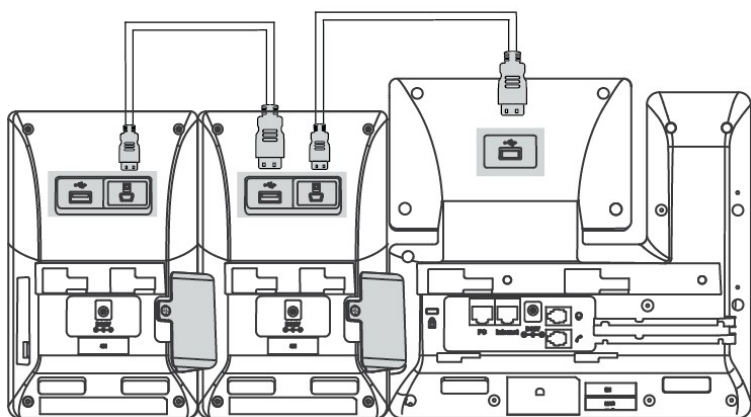

**Note:** Power is automatically transferred from the host phone to the expansion module(s) upon connection. If you want to use more than one expansion module on a single phone, you need to connect an additional Yealink power adapter (5V/2A) to any one of the expansion modules.

The power adapter should be purchased separately.

**To attach the stand of the expansion module:**

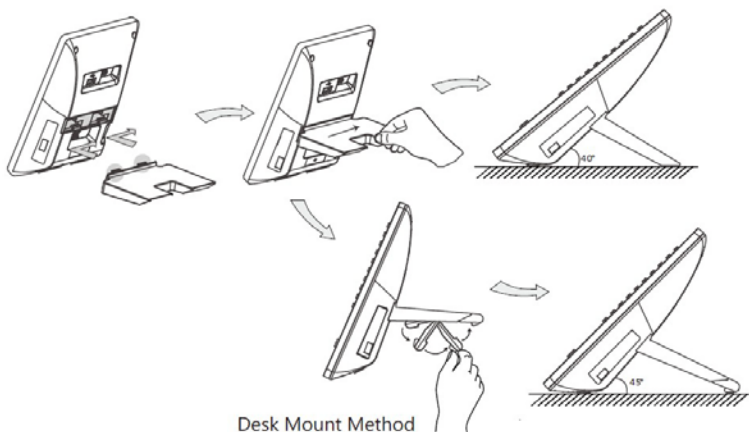

**End.**